

# IN-DUCT CORNER CONDENSATE PUMPS



DATA SHEET

AC

The HYP-D11 and HYP-D21 are condensate pumps for installation inside plastic ducting alongside the insulated cooling pipes. These pumps are suitable for installations up to 15,000 BTU and pumping heads up to 8 metres. The pumps are CE certified and come complete with high-level alarm volt-free contacts and pump motor overload protection.

230V

3W

2 YEAR  
GUARANTEE

Quiet and no vibration

Highly reliable

High flow rate



**PHOENIX**  
CONDENSATE PUMPS

## Specification: HYP-D11

Input Voltage:	100-230V AC, 50Hz-60Hz
Pumping Head:	8 metres
Max Flow Rate:	12ltr/hr
Tank Capacity:	55ml
Noise Level:	19dBA
Maximum Cooling Capacity:	8kW (30,000BTU)
Ambient Temperature:	0-50°C
Power Consumption:	3W

## HYP-D21

Input Voltage:	100-230V AC, 50Hz-60Hz
Pumping Head:	8 metres
Max Flow Rate:	20ltr/hr
Tank Capacity:	55ml
Noise Level:	21dBA
Maximum Cooling Capacity:	15kW (45,000BTU)
Ambient Temperature:	0-50°C
Power Consumption:	3W

## Dimensions

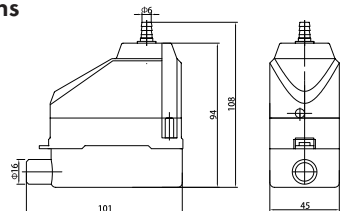

Version 1. 11/2019

**HYDRON**

**HYDRON PUMPS**

Unit 3, Drake Business Park  
Drake House Crescent, Sheffield, S20 7HT

T: 01246 432325

F: 01246 432324

E: sales@hydronpumps.co.uk

## Additional Information

- Compact construction and easy assembly
- Compact modern design

## Flow Rates

HORIZONTAL RUN	PERFORMANCE				
	0m	2m	4m	6m	8m
<b>HYP-D11</b>					
1m	12ltr/hr	10ltr/hr	7ltr/hr	6ltr/hr	5ltr/hr
5m	10ltr/hr	9ltr/hr	6ltr/hr	4ltr/hr	3ltr/hr
10m	9ltr/hr	8ltr/hr	5ltr/hr	-	-
15m	8ltr/hr	7ltr/hr	-	-	-
HORIZONTAL RUN	PERFORMANCE				
	0m	2m	4m	6m	8m
<b>HYP-D21</b>					
1m	20ltr/hr	18ltr/hr	10ltr/hr	9ltr/hr	8ltr/hr
5m	17ltr/hr	15ltr/hr	13ltr/hr	11ltr/hr	8ltr/hr
10m	16ltr/hr	12ltr/hr	10ltr/hr	8ltr/hr	6ltr/hr
15m	14ltr/hr	12ltr/hr	8ltr/hr	5ltr/hr	-

Code	Maximum Cooling Capacity	Dimensions (L x W x D mm)
HYP-D11	8kw(30,000btu)	105 x 46 x 50
HYP-D21	15kw(45,000btu)	105 x 46 x 50